

FOR COMPARTMENT PRESSURE

Remove Compass UniversalHg from its sterile package.

Remove the proximal luer cap and connect Compass UniversalHg to 18G needle and saline filled syringe (**Figure 1**).

Prime Compass UniversalHg and needle with syringe.

With Compass UniversalHg and needle positioned at the angle of insertion (**Figure 2**) activate and calibrate Compass UniversalHg by depressing the blue power button for approximately one second until the display reads "00 mm" (**Figure 3**).

Insert needle tip (**Figure 4**) and inject 0.3 ml of saline to clear any tissue from the needle tip.

Pressure is displayed on Compass UniversalHg LCD (**Figure 5**).

Additional compartment measurements can be obtained during the same procedure on the same patient.

Device Power Off and Recalibration

Press button three times in a "PUSH – PUSH – HOLD" 18G needle (i.e. quickly push button twice and then hold the third button push until device turns off). To recalibrate the device, depress the power button with accessories assembled to the device and positioned at the angle of insertion until display reads "00 mm".

For complete instructions and warnings, consult the IFU supplied with the device.

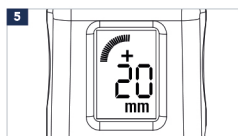
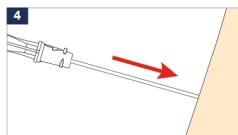
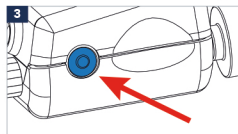
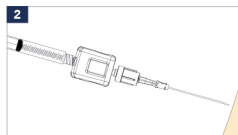
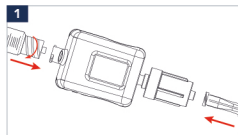

18G needle